

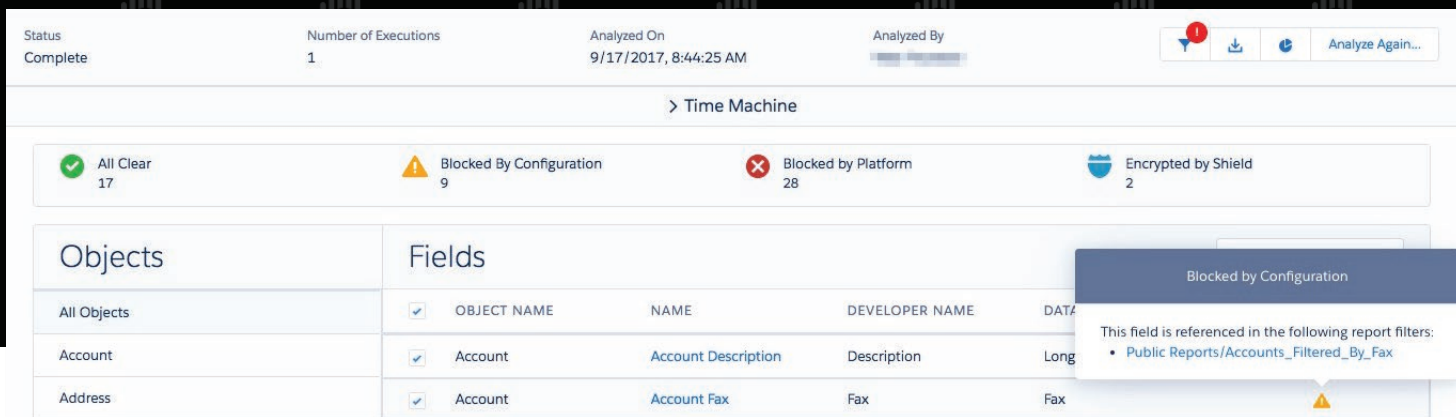

Shield Security Cockpit

Analyzer for Salesforce Shield Platform Encryption



Key Benefits



Reduce maintenance and audit time up to 80%



Instantly see the encryption status of all fields accurately in real-time



Export encryption status reports for InfoSec any time and with confidence



Keep up to date with changes to your org & Salesforce releases

Use Cases



Shield Implementation

Know which fields can and can't be encrypted. Know which fields require mitigation and why.



Encryption Maintenance & Audits

Quickly and easily ensure regulatory compliance (e.g. HIPAA, SOX) with Shield.

The manual process of understanding which fields can't be encrypted and why is very time intensive.

Streamline this process with RevCult's Shield Security Cockpit by quickly identifying which fields:



Are ready for encryption



Require mitigation and where to fix these issues



Can't be encrypted based on Salesforce rule set



Are already encrypted by Salesforce Shield

Shield Security Coc...

Home

Platform Encryption Analyzer

Settings J

SHIELD SECURITY COCKPIT

PLATFORM ENCRYPTION ANALYZER

POWERED BY

RevCult

B

C

I

Analyze Again...

Status

Complete

Number of Executions

1

Analized On

9/17/2017, 8:44:25 AM

Analized By

> Time Machine

H

All Clear

17

Blocked By Configuration

9

Blocked by Platform

28

Encrypted by Shield

2

Objects

All Objects	<input checked="" type="checkbox"/>	OBJECT NAME	NAME	DEVELOPER NAME	DATA
Account	<input checked="" type="checkbox"/>	Account	Account Description	Description	Long
Address	<input checked="" type="checkbox"/>	Account	Account Fax	Fax	Fax
Asset	<input checked="" type="checkbox"/>	Account	Account Name	Name	Name
Asset Relationship	<input checked="" type="checkbox"/>	Account	Account Number	AccountNumber	Text(40)

Fields

<input checked="" type="checkbox"/>	OBJECT NAME	NAME	DEVELOPER NAME	DATA
<input checked="" type="checkbox"/>	Account	Account Description	Description	Long
<input checked="" type="checkbox"/>	Account	Account Fax	Fax	Fax
<input checked="" type="checkbox"/>	Account	Account Name	Name	Name
<input checked="" type="checkbox"/>	Account	Account Number	AccountNumber	Text(40)

Blocked by Configuration

This field is referenced in the following report filters:

- Public Reports/Accounts_Filtered_By_Fax

F

Glossary

- All Clear:** These fields can be encrypted right away if desired
- Blocked by Configuration:** These fields do not comply with the Salesforce.com rules, but there are possible mitigation steps that can be taken to allow encryption
- Blocked by Platform:** These fields do not comply with the Salesforce.com rules, and it is not possible at this time to encrypt them
- Encrypted by Shield:** These fields are encrypted by Salesforce Shield Platform Encryption

A History of Prior Analysis Executions

Status
Number of Executions

Last Analysis Date/Time
Last Analysis By

Status	Number of Executions	Last Analysis	Last Analysis By
Complete	2	7/21/2017 8:48:27 AM	

B Advanced Filter

Quickly navigate your Objects and Fields to streamline data classification.

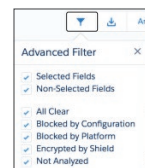

C Download Encryption Status Results (CSV)

Export reports for InfoSec on your encryption status.

A	B	C	D	E	F
Object Name	Field Name	Api Name	Data Type	Status	Reason Blocked
Account	Description	Long Text Area(32000)	Clear	All clear to encrypt.	
Account	Fax	Phone	Clear	All clear to encrypt.	
Account	Name	Text(255)	Clear	All clear to encrypt.	
Account	AccountNumber	Text(40)	Platform	The platform does not allow the encryption of this standard field	

D Summary of Current Status of Selected Fields

See glossary for status definitions.

All Clear	Blocked By Configuration	Blocked by Platform	Encrypted by Shield
25	9	42%	2

E Field Explorer

Find and select your Objects and Fields. The field explorer can be used as an enabler/discovery tool for the data classification conversation. Simply check the box next to each field you'd like to analyze.

G Field Result Details

Hover over icon for details on why a result was determined. If the field was blocked by configuration, a link is provided, directing the user to where the field is referenced. This allows the user to determine what configuration changes are required to encrypt a field without negative impact.

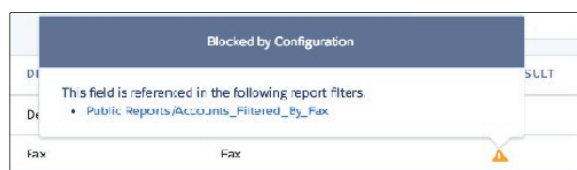

F Field Specific Results

When the analysis is completed, the fields you selected in Field Explorer will show you the status for each field. See glossary for status definitions.

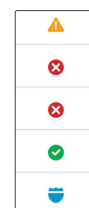

See it live in action!
Sign up for a demo here:
info.revicult.com/shield-demo

Shield Security Coc...

Home

Platform Encryption Analyzer

Settings

SHIELD SECURITY COCKPIT

PLATFORM ENCRYPTION ANALYZER

STATUS

Complete

Number of Executions

1

ANALYZED ON

9/17/2017, 8:44:25 AM

ANALYZED BY

Blocked By Configuration

9

Blocked By Platform

28

Encrypted by Shield

2

Time Machine

OBJECTS

All Objects	<input checked="" type="checkbox"/>	OBJECT NAME	NAME	DEVELOPER NAME	DATA
Account	<input checked="" type="checkbox"/>	Account	Account Description	Description	Long
Address	<input checked="" type="checkbox"/>	Account	Account Fax	Fax	Fax
Asset	<input checked="" type="checkbox"/>	Account	Account Name	Name	Name
Asset Relationship	<input checked="" type="checkbox"/>	Account	Account Number	AccountNumber	Text(40)

FIELDS

<input checked="" type="checkbox"/>	OBJECT NAME	NAME	DEVELOPER NAME	DATA
<input checked="" type="checkbox"/>	Account	Account Description	Description	Long
<input checked="" type="checkbox"/>	Account	Account Fax	Fax	Fax
<input checked="" type="checkbox"/>	Account	Account Name	Name	Name
<input checked="" type="checkbox"/>	Account	Account Number	AccountNumber	Text(40)

Blocked by Configuration

This field is referenced in the following report filters:

- Public Reports/Accounts_Filtered_By_Fax

H Time Machine

View your org's configuration as it appeared during any prior analysis.

STATUS

Complete

Number of Executions

1

ANALYZED ON

9/17/2017, 8:44:25 AM

ANALYZED BY

Time Machine

Advanced Filter

☒ Selected Fields
 ☐ Non-Selected Fields

☒ All Clear
 ☒ Blocked by Configuration
 ☒ Blocked by Platform
 ☒ Encrypted by Shield
 ☒ Not Analyzed

You are currently viewing a snapshot from the Time Machine (9/17/2017 at 8:44:25 AM by).

Click here to leave the Time Machine and return to the present.

I Download a PDF Compliance Report

View your org's configuration as it appeared during any prior analysis.

SHIELD SECURITY COCKPIT

PLATFORM ENCRYPTION ANALYZER

STATUS

Complete

Executions

2

LAST ANALYSIS

9/17/2017, 8:58:41 AM

LAST ANALYSIS BY

56 Fields Selected

All Clear

29 (A12)

Blocked By Configuration

10 (A1)

Blocked By Platform

15 (T13)

Encrypted by Shield

2

Total Fields

760

Fields Selected

56

Encrypted Since Prior Analysis

OBJECT	FIELD NAME	API NAME	DATATYPE
No data available in table			

Modified Since Prior Analysis

☐ Currently Selected Analysis
 ☒ Prior Analysis

OBJECT	FIELD NAME	API NAME	DATATYPE	SELECTED	RESULT
Account	Billing Address	BillingAddress	Address	<input checked="" type="checkbox"/>	
Account	Billing Address	BillingAddress	Address	<input checked="" type="checkbox"/>	
Account	Shipping Address	ShippingAddress	Address	<input checked="" type="checkbox"/>	
Account	Shipping Address	ShippingAddress	Address	<input checked="" type="checkbox"/>	
Contact	Ass. Phone	AssistantPhone	Phone	<input checked="" type="checkbox"/>	
Contact	Ass. Phone	AssistantPhone	Phone	<input checked="" type="checkbox"/>	

J Settings

Easily Check your org against the rules in upcoming versions of the API and against any Beta or Pilot settings you have opted into with Salesforce.com.

Shield Security Coc...

Home

Platform Encryption Analyzer

Settings

SHIELD SECURITY COCKPIT

SETTINGS

General Settings

API VERSIONS

☒ 40.0 (Summer '17)
 ☐ 41.0 (Winter '18)

BETA FEATURES

☐ Lead Fields
 ☐ Opportunity Description / Next Step

PILOT FEATURES

☐ Opportunity Name

Apply Changes

Cancel

See it live in action!
 Sign up for a demo here:
info.revicult.com/shield-demo

RevCult

www.revicult.com | 619.786.8020 | 12555 High Bluff Dr Suite 255, San Diego, CA 92130